

TREYPART®

TRAILER SPARE PARTS CATALOG

www.treypart.com

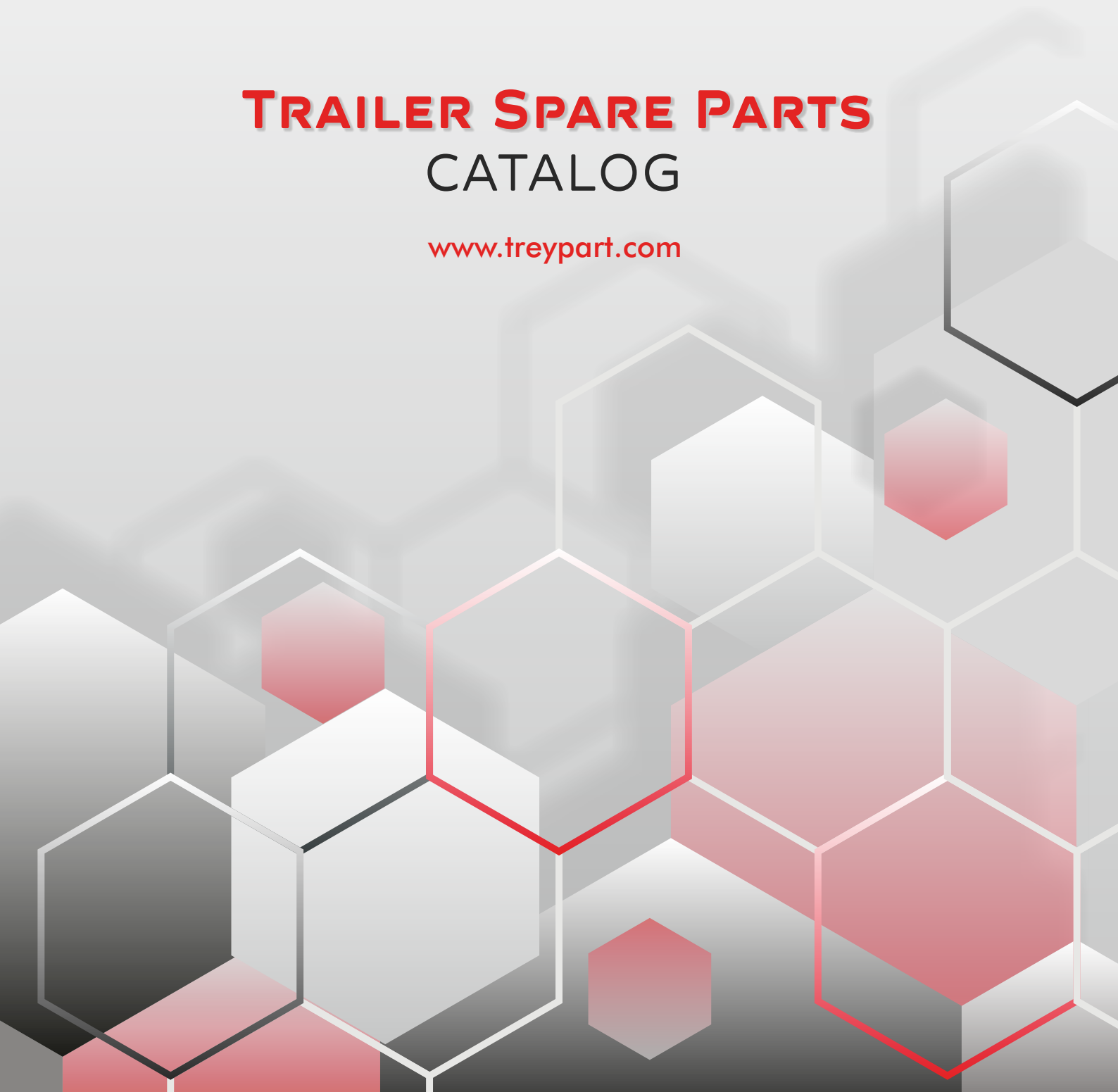

TREYPART®



PREFACE

Our company, founded in 2016 with the support of our valued customers and the knowledge and experience gained by joining the sector in 2006, continues its activities in a closed area of 1000 m2.

In a short time, our company has achieved great success and had a significant share in the sector. TREYPART OTOMOTIV, following the technology with its experienced personnel and adopting the principle of customer-oriented work, meets the expectations and competencies of its domestic and international customers.

We would like to thank you our valued customers, who have contributed to us to increase and diversify your product range since its establishment.

TREYPART[®]

INDEX

AXLES	1
LEAF SPRING	7
AIR SPRING	10
CONNECTING EQUIPMENTS	19
BRAKE EQUIPMENTS	22
BRAKE SYSTEM & VALVES	25
ELECTRICAL PARTS & WARNING SINGS	30
MUDGUARDS	33
OTHER EQUIPMENTS	38

AXLES



TREYPART[®]

DRUM AXLE

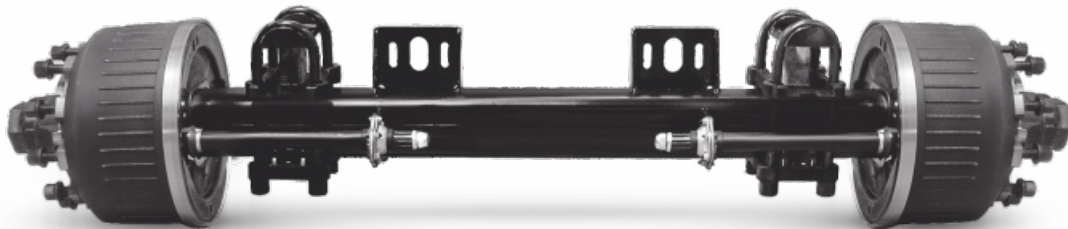

Technical Specifications

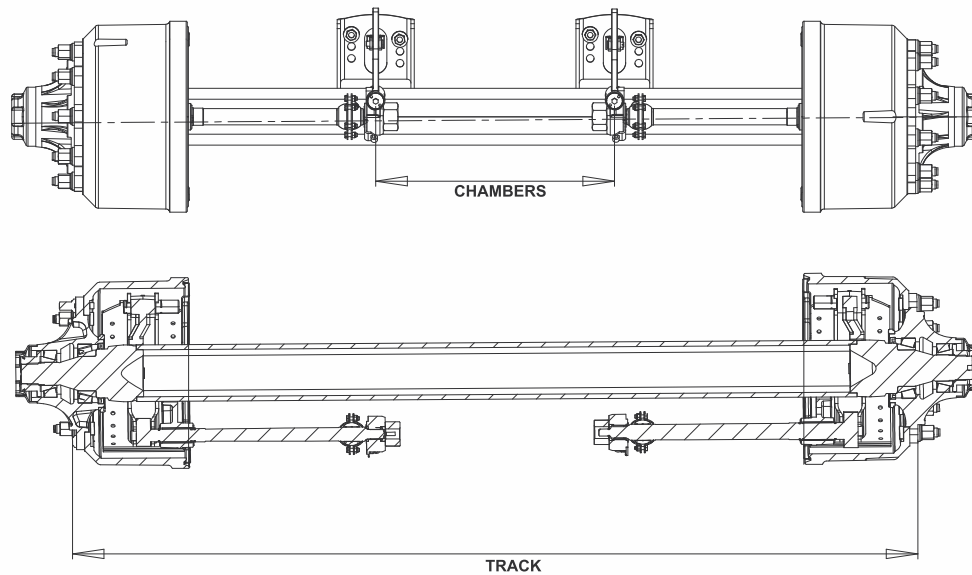

Technical Details

Reference: 30.40.744.564

Type	Track	Chambers	Beam	Bearing
12 Ton Pilot	2080 mm	600 mm	140 x 14 mm	33213 - 218248
12 Ton Double	1840 mm	360 mm	140 x 14 mm	33213 - 218248
14 Ton Double	1840 mm	360 mm	140 x 14 mm	33019 - 33215
16 Ton Double	1840 mm	360 mm	140 x 14 mm	32314- 32222

DRUM AXLE KIT



Technical Specifications

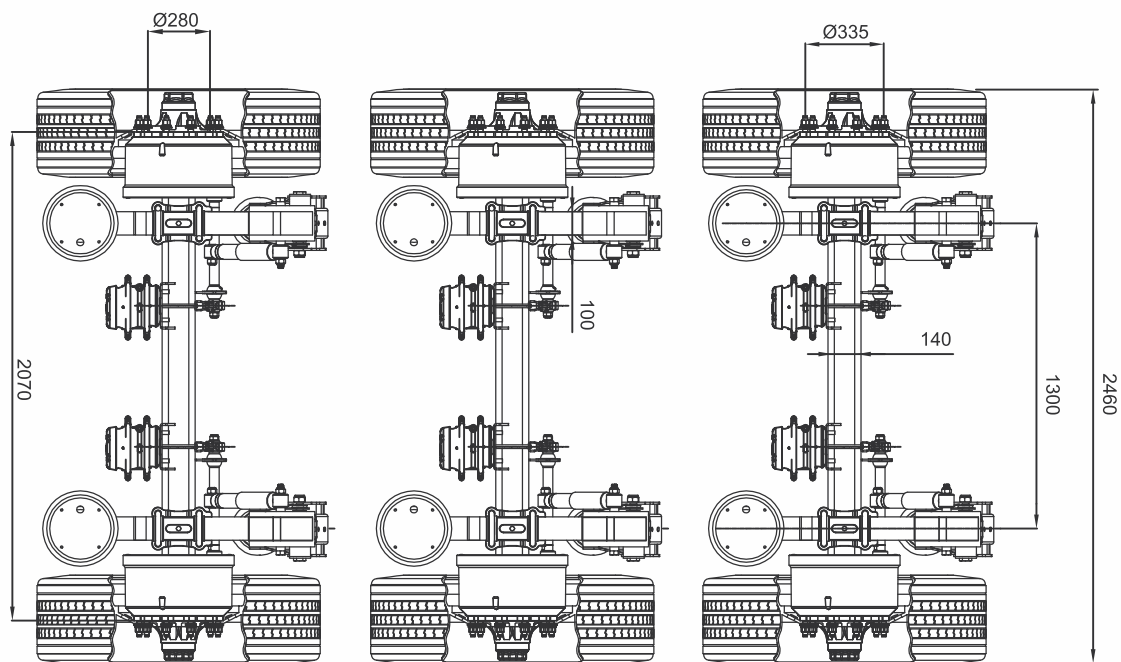

Technical Details

Reference: 61.40.064.027

Type	Track	Chambers	Beam	Bearing
12 Ton Pilot	2080 mm	600 mm	140 x 14 mm	33213 - 218248
12 Ton Double	1840 mm	360 mm	140 x 14 mm	33213 - 218248
14 Ton Double	1840 mm	360 mm	140 x 14 mm	33019 - 33215
16 Ton Double	1840 mm	360 mm	140 x 14 mm	32314- 32222

DISC AXLE KIT

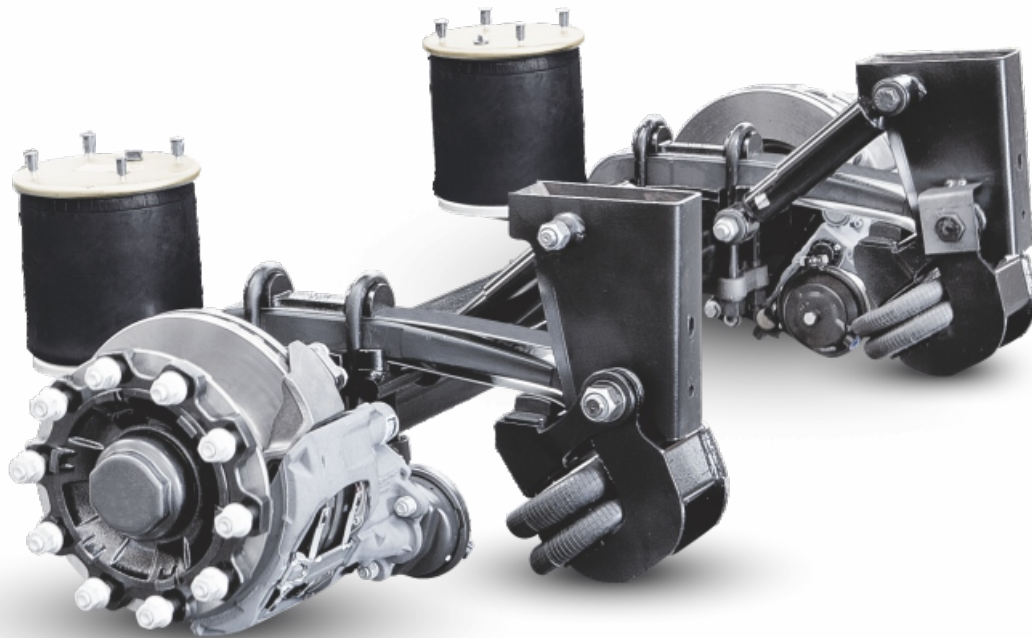

Technical Specifications

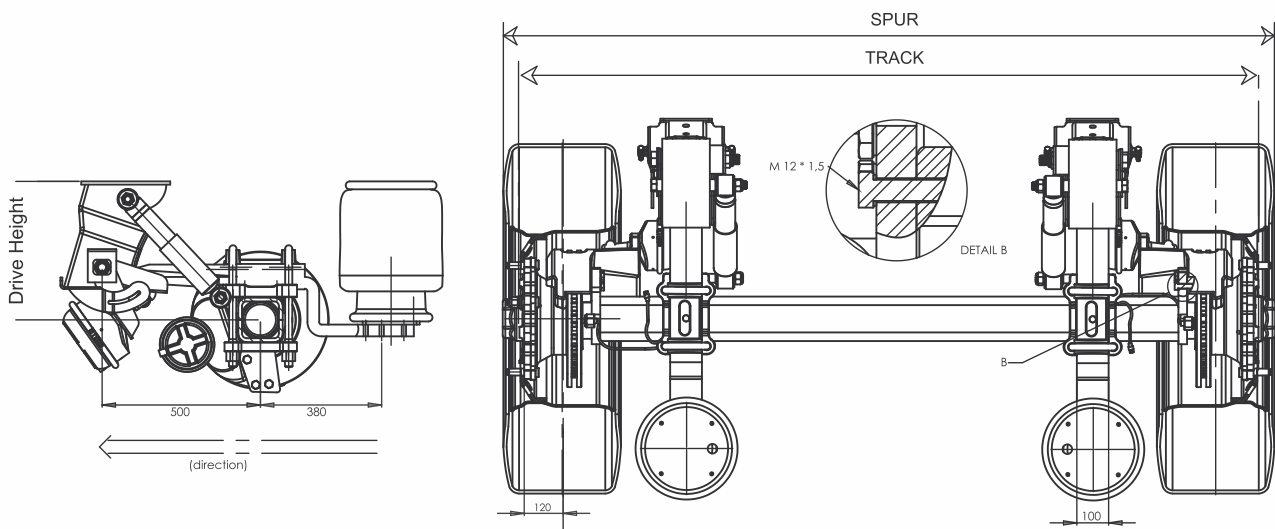

Technical Details

Reference: 61.58.088.615

Type	Track	Brake	Beam	Bearing	Spur
12 Ton Pilot	2290 mm	420 x 200 mm	140 x 14 mm	33213 - 218248	2430 mm

JUMBO AXLE KIT



Technical Specifications

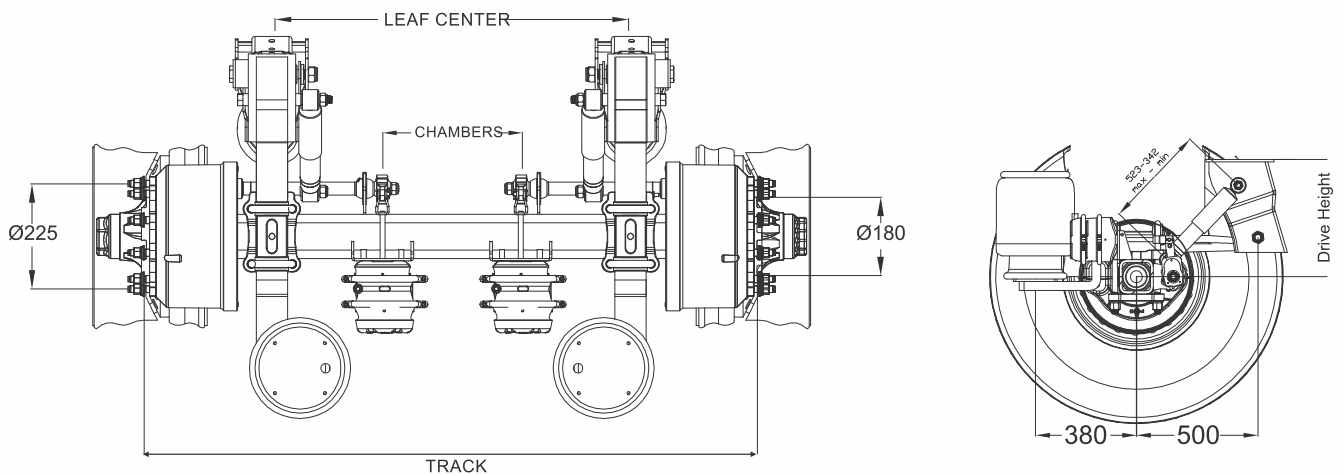

Technical Details

Reference: 30.10.546.829

Type	Track	Chambers	Beam	Bearing
17.5 Rim	1840 mm	360 mm	140 x 14 mm	33213-218248
19.5 Rim	1840 mm	360 mm	140 x 14 mm	33213-218248

MECHANICAL SUSPENSION KIT

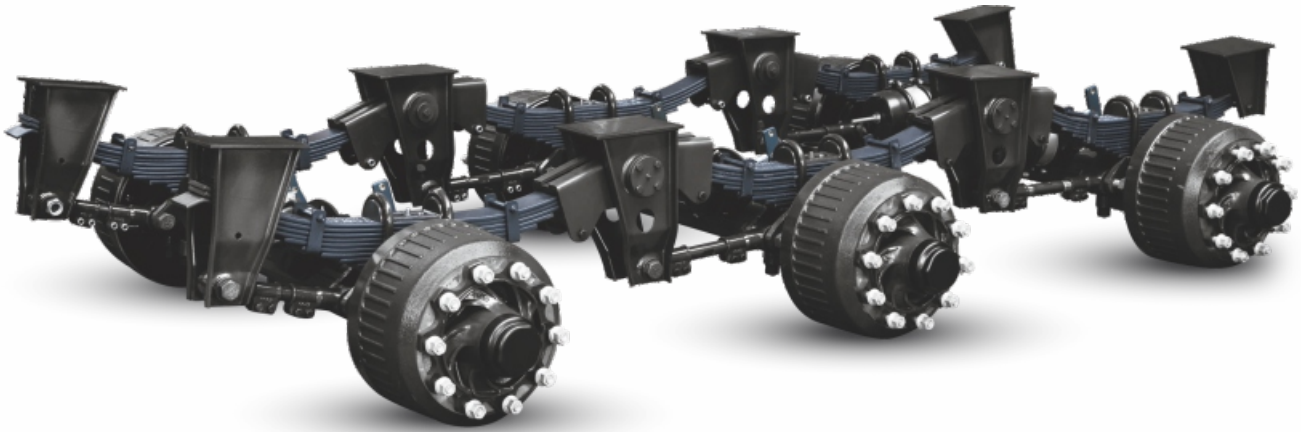

Technical Specifications

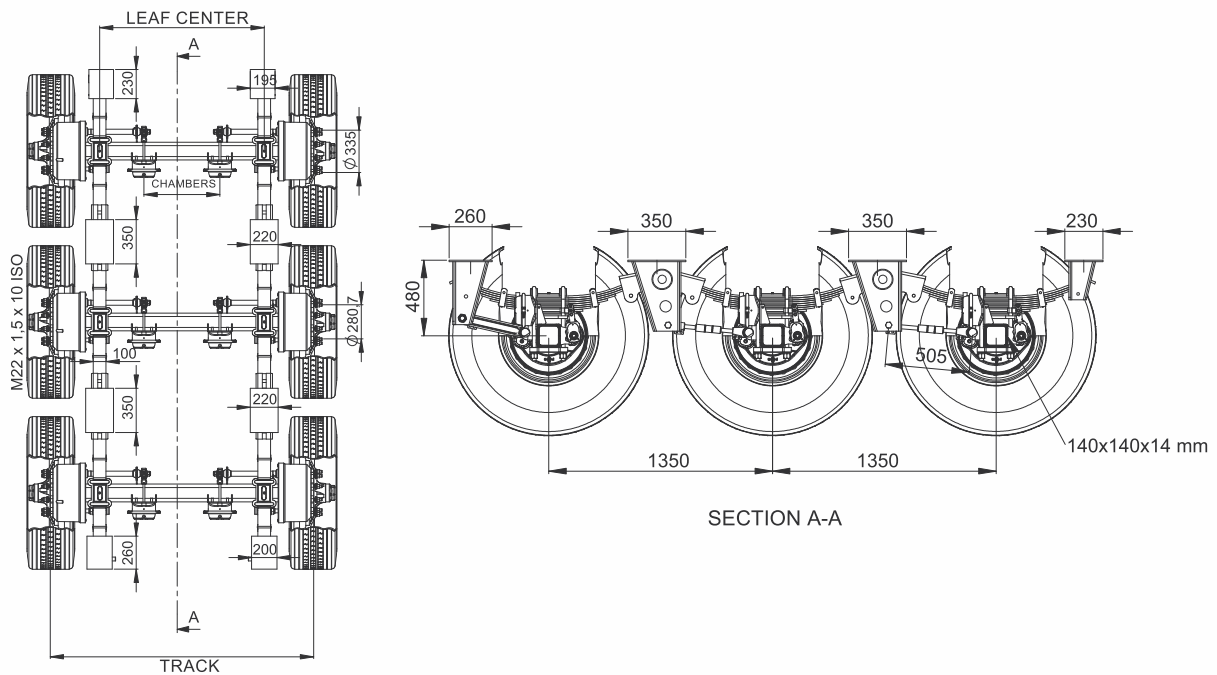

Technical Details

Reference: 21.10.723.584

Type	Track	Chambers	Beam	Bearing
12 Ton Tridem	1840 mm	360 mm	140 x 14 mm	33213 - 218248
14 Ton Tridem	1840 mm	360 mm	140 x 14 mm	33019 - 33215
16 Ton Tridem	1840 mm	360 mm	140 x 14 mm	32314- 32222

LEAF SPRING



TREYPART[®]

PARABOLIC Z SPRING

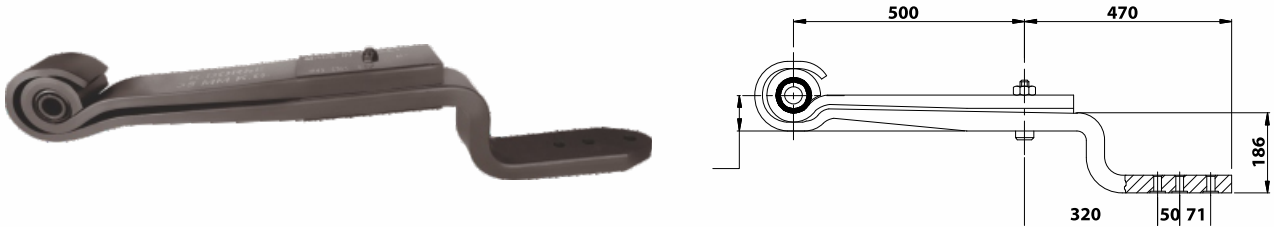

Technical Specifications

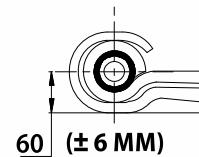
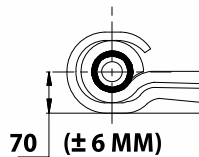
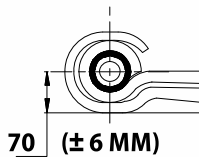

Technical Details	Reference: 05.082.12.63.0	Technical Details	Reference: 05.082.12.63.0	Technical Details	Reference: 05.082.12.63.0
35/100 MM 57 MM BUSHING		38/100 MM 57 MM BUSHING		38/100 MM 68 MM BUSHING	
CODE: ZM-1000-001		CODE: ZM-1000-002		CODE: ZM-1000-003	

PARABOLIC Z SPRING W/SAFETY



Technical Specifications

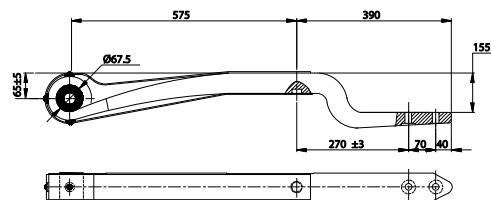
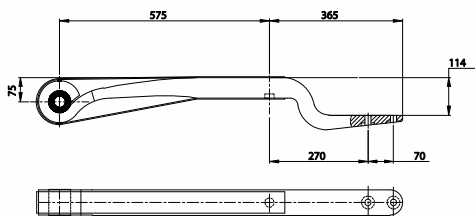

Technical Details	Reference: 05.082.13.95.0	Technical Details	Reference: 05.082.13.95.0
62/70 MM 60 MM BUSHING		52/100 MM 68 MM BUSHING	
CODE: ZM-1100-001		CODE: ZM-1100-003	

FLAT SPRING



Technical Specifications

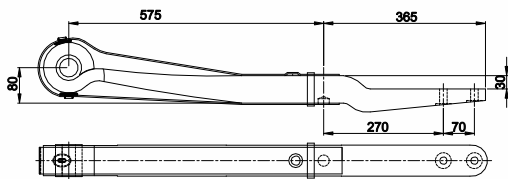

Technical Details

Reference:
05.082.13.96.0

62/70 MM 60 MM BUSHING

CODE: ZM-1100-002

LOWBED SPRING



Technical Specifications

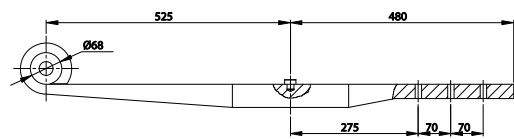

Technical Details

50 / 100 MM LOWBED 68 MM BUSHING

CODE: ZM-1200-002

LOWBED SPRING DOUBLE LAYER



Technical Specifications

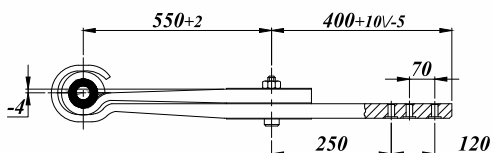

Technical Details

Reference:
05.082.13.21.0

35/100 MM LOWBED 57 MM BUSHING

CODE: ZM-1200-001

SPRING LEAVES



Technical Specifications

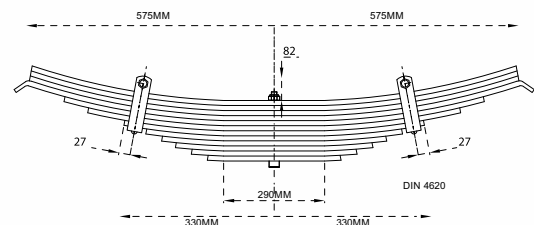

Technical Details

Reference:
05.082.04.02.0

100 x 12 10 Leaves

100 x 12 12 Leaves

100 x 12 14 Leaves

CODE: ZM-1300-001

CODE: ZM-1300-002

CODE: ZM-1300-003

AIR SPRING



TREYPART®

TP 813-K

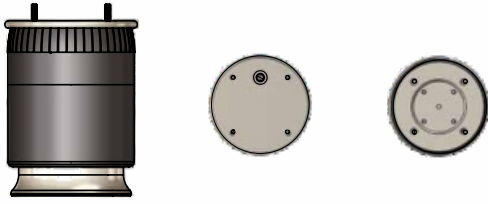

Technical Specifications

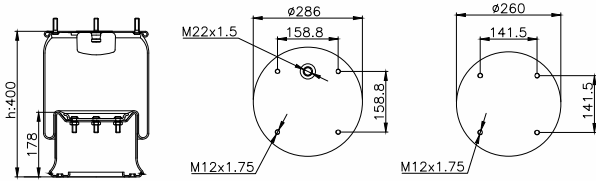

Technical Details **Reference: 2.229.2103.00**
CODE: SK-1400-813K

TP 881-K

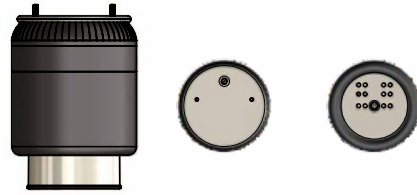

Technical Specifications

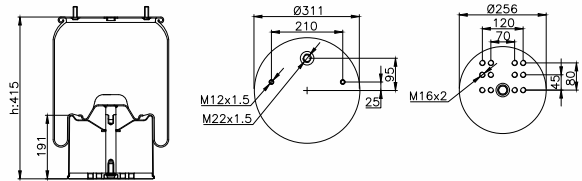

Technical Details **Reference: 05.429.40.61.1**
CODE: SK-1400-881K

TP 4881-K

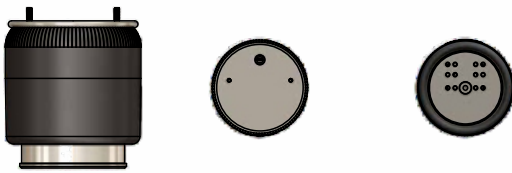

Technical Specifications

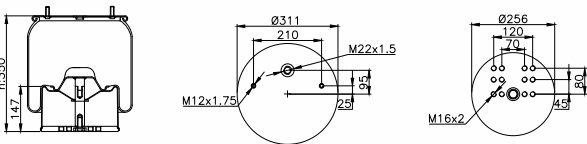

Technical Details **Reference: 05.429.41.22.1**
CODE: SK-1400-4881K

TP 940-K

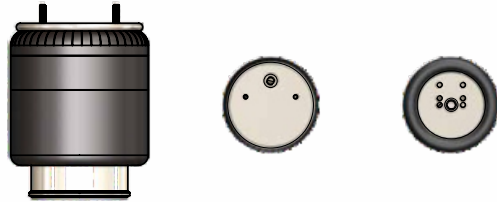

Technical Specifications

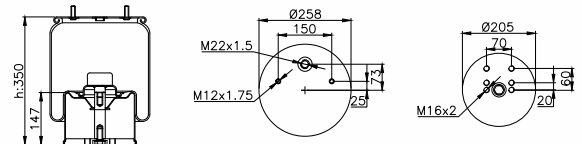

Technical Details **Reference: 05.429.41.28.1**
CODE: SK-1400-940K

TP 941-K



Technical Specifications

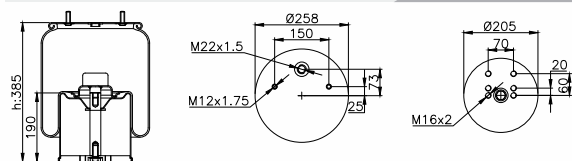

Technical Details **Reference: 05.429.40.03.0**
CODE: SK-1400-941K

TP 4022-KPO5



Technical Specifications

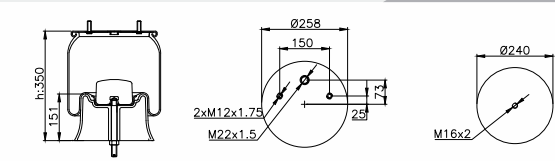

Technical Details **Reference: 3.229.0033.00**
CODE: SK-1400-4022K05

TP 4023-K



Technical Specifications

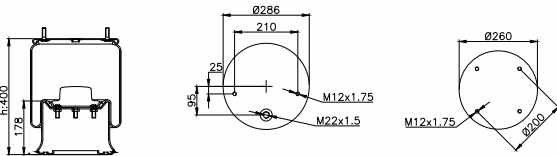

Technical Details **Reference: 3.229.0031.00**
CODE: SK-1400-4023K

TP 0722-K

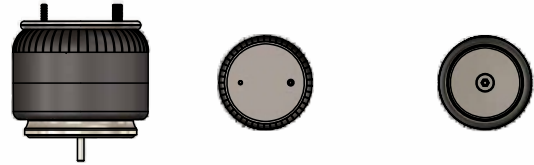

Technical Specifications

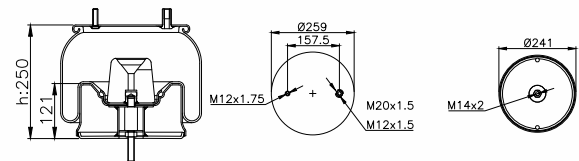

Technical Details **Reference: V1DK27-B2**
CODE: SK-1400-0722K

TP 1889-K

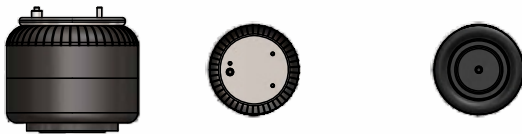

Technical Specifications

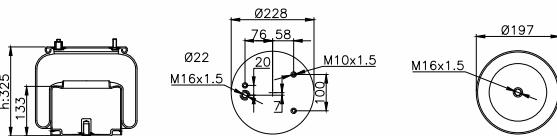

Technical Details **Reference: 9C46-5580-BA**
CODE: SK-1400-1889K

TP 2725-K

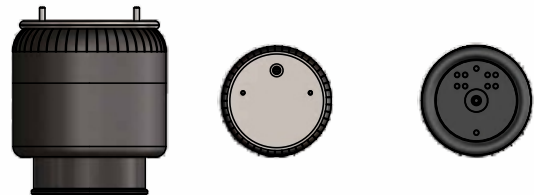

Technical Specifications

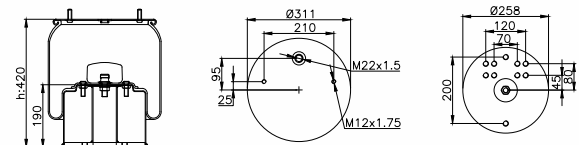

Technical Details **Reference:**
CODE: SK-1400-2725K

TP 4156-K



Technical Specifications

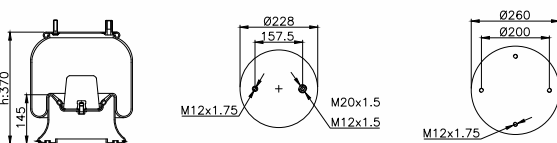

Technical Details **Reference: M001472**
CODE: SK-1400-4156K

TP 4157-KPO5

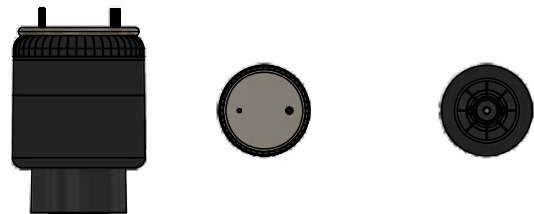

Technical Specifications

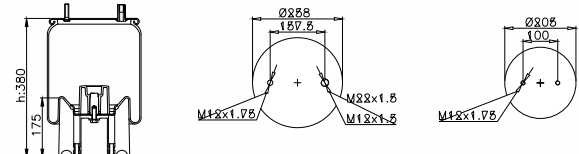

Technical Details **Reference: US 07074C**
CODE: SK-1400-4157K05

TP 4158-KP



Technical Specifications

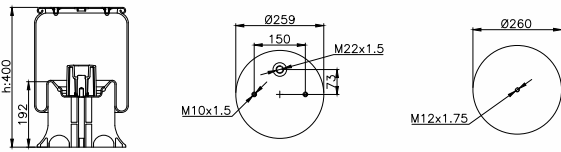

Technical Details **Reference: 014 892**

CODE: SK-1400-4158KP

TP 4159-KP



Technical Specifications

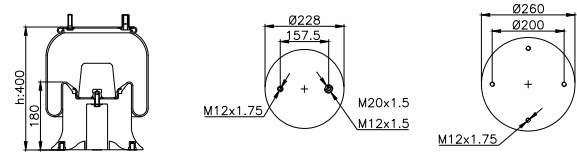

Technical Details **Reference: UJA 0894-001**

CODE: SK-1400-4159KP

TP 810-K16



Technical Specifications

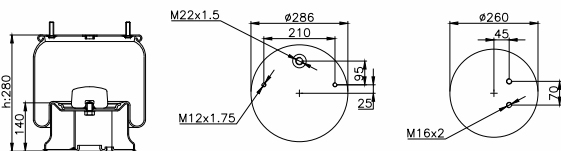

Technical Details **Reference:**

CODE: SK-1400-810K16

TP 4183-K23

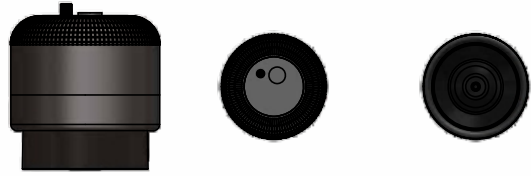

Technical Specifications

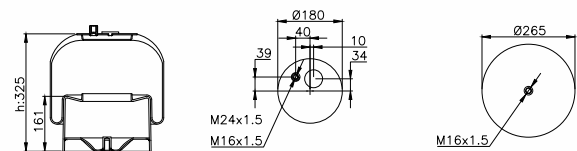

Technical Details **Reference: A 942320 22 21**

CODE: SK-1400-4183K

TP 4390-KO1

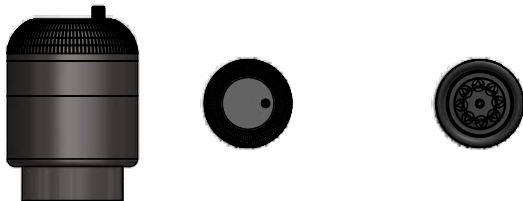

Technical Specifications

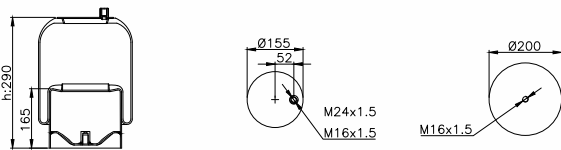

Technical Details **Reference: A 942 320 28 21**

CODE: SK-1400-4390K

TP 4882-K

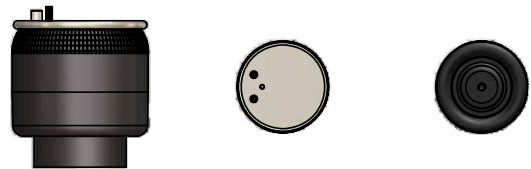

Technical Specifications

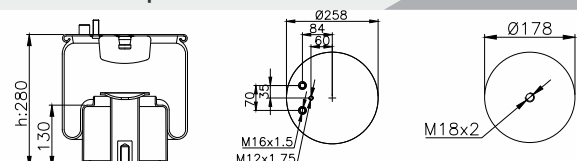

Technical Details **Reference: 81.436.006.036**

CODE: SK-1400-4882K

TP 4884-K

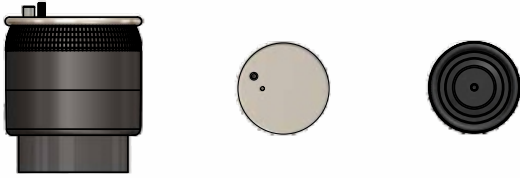

Technical Specifications

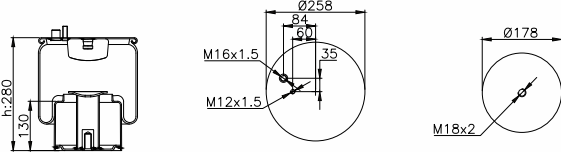

Technical Details **Reference: 81.436.006.035**
CODE: SK-1400-4884K

TP 4912-KO1

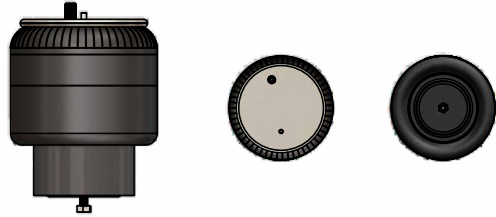

Technical Specifications

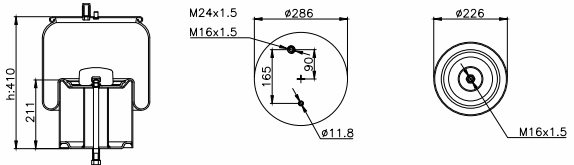

Technical Details **Reference: 5.010.557.355**
CODE: SK-1400-4912K

TP 4913-K

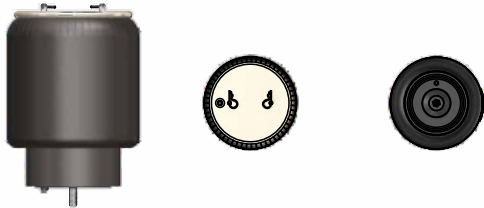

Technical Specifications

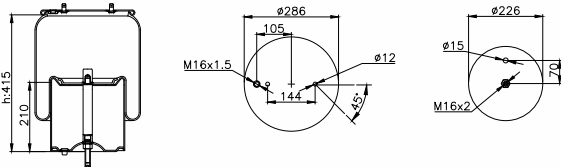

Technical Details **Reference: 1379392**
CODE: SK-1400-4913K

TP 6122-KPO1

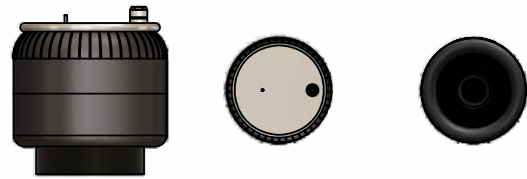

Technical Specifications

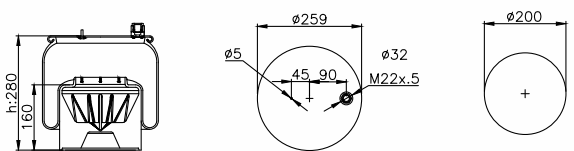

Technical Details **Reference: A 960 32000 57**
CODE: SK-1400-6122KP

TP 6318-KP

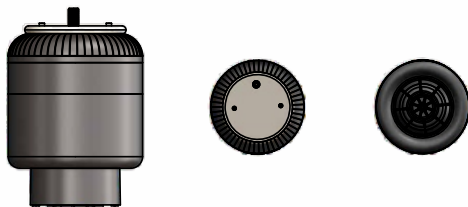

Technical Specifications

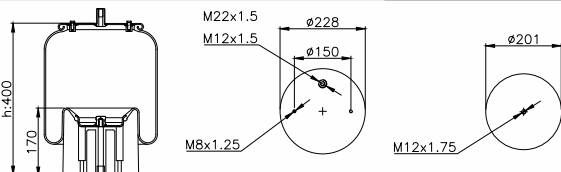

Technical Details **Reference: 016 512**
CODE: SK-1400-6318KP

TP 6290-KPO1

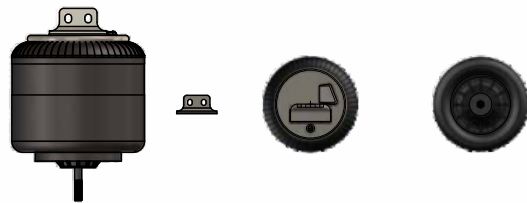

Technical Specifications

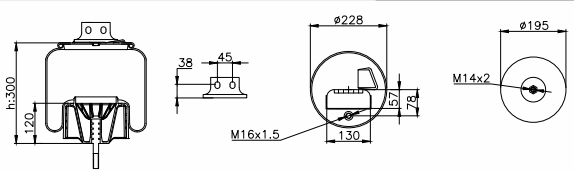

Technical Details **Reference: 41270462**
CODE: SK-1400-6290K01

TP 6416-K

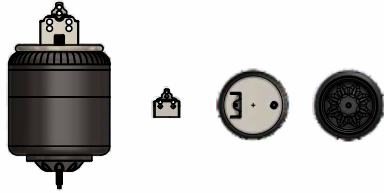

Technical Specifications

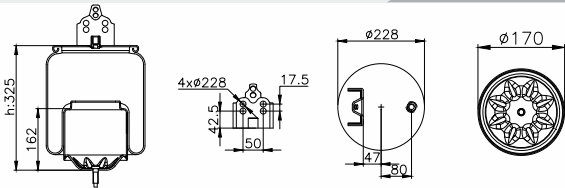

Technical Details **Reference: 1 075 891**
CODE: SK-1400-6416K

TP 6418-K

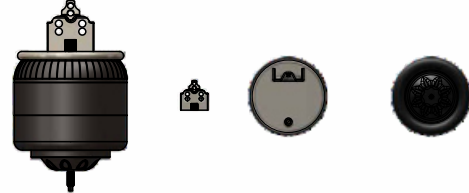

Technical Specifications

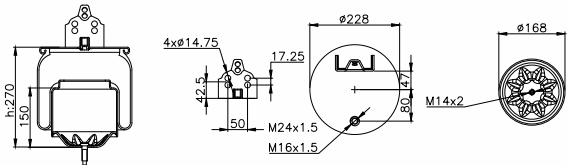

Technical Details **Reference: 1 076 418**
CODE: SK-1400-6418K

TP 608-K

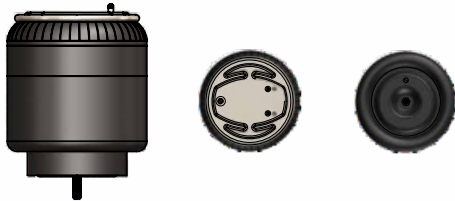

Technical Specifications

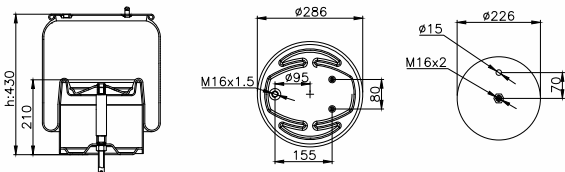

Technical Details **Reference: 1903608**
CODE: SK-1400-608K

TP 7803-K

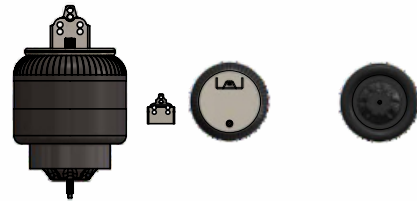

Technical Specifications

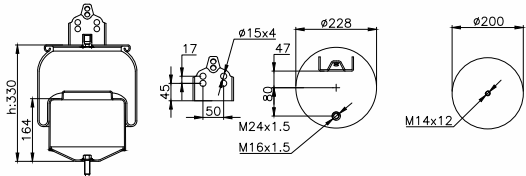

Technical Details **Reference: 1 075 890**
CODE: SK-1400-7803K

TP 7804-K

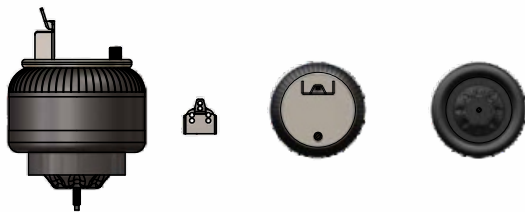

Technical Specifications

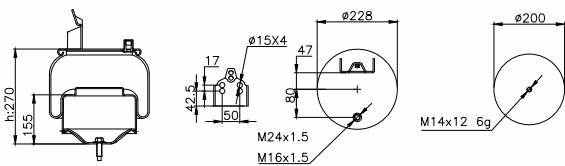

Technical Details **Reference: 20 375 227**
CODE: SK-1400-7804K

TP 836-KO1

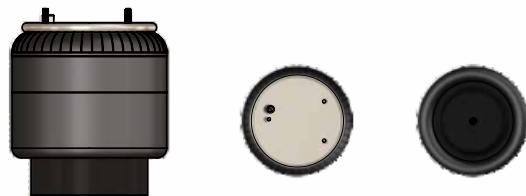

Technical Specifications

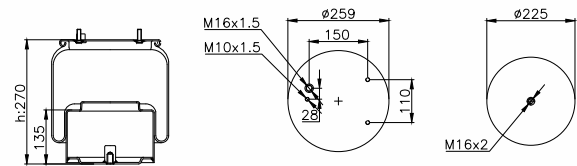

Technical Details **Reference: 0 388 165**
CODE: SK-1400-836K

TP D 220-01

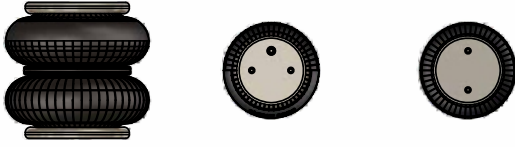

Technical Specifications

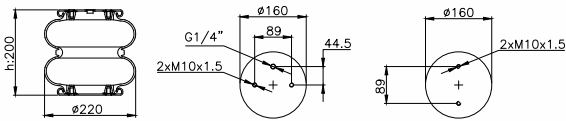

Technical Details **Reference: 113549**

CODE: SK-1000-003

TP D 220-03



Technical Specifications

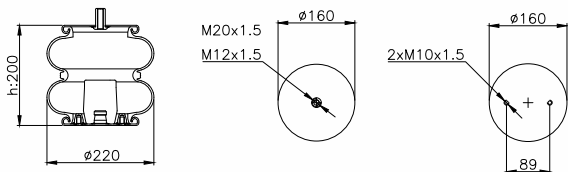

Technical Details **Reference: HS507907/P**

CODE: SK-1000-005

TP D 220-05



Technical Specifications

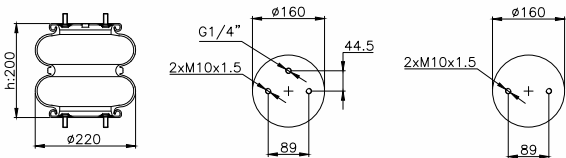

Technical Details **Reference: 113021**

CODE: SK-1000-001

TP D 300



Technical Specifications

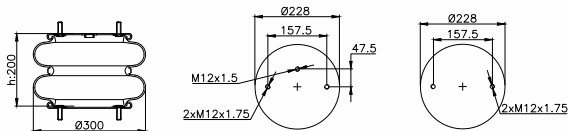

Technical Details **Reference:**

CODE: SK-1100-002

TP D 315

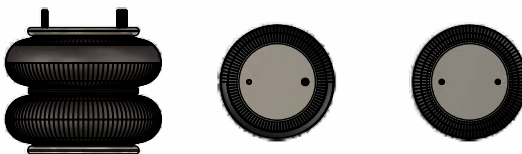

Technical Specifications

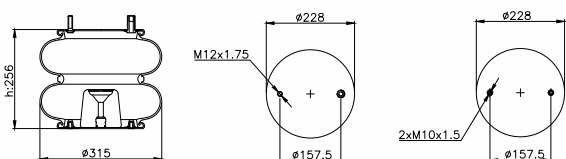

Technical Details **Reference: HS507907/P**

CODE: SK-1100-001

TP T305 (4 PLY)



Technical Specifications

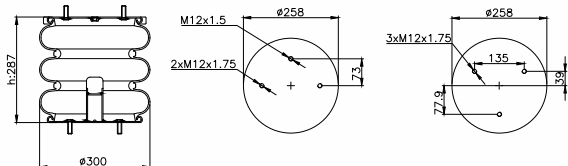

Technical Details **Reference: 57RS3066424**

CODE: SK-1200-001

TP 644



Technical Specifications

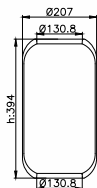

Technical Details **Reference: 81.436.010.017**
CODE: SK-1400-644R

TP 673



Technical Specifications

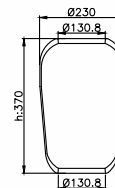

Technical Details **Reference: A 383 32700 01**
CODE: SK-1400-673R

TP 720



Technical Specifications

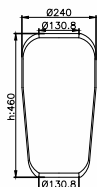

Technical Details **Reference: 81.436.010.033**
CODE: SK-1400-720R

TP 884



Technical Specifications

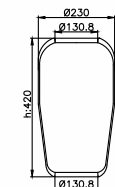

Technical Details **Reference: 81.43601.0066**
CODE: SK-1400-884R

TP CA 11041



Technical Details **Reference: A 942 890 61 19**
CODE: KK-1300-001

TP CA 11042



Technical Details **Reference: A 942 890 49 19**
CODE: KK-1300-002

TP C 321207



Technical Details

Reference: 1424231

CODE: KK-1001-001

TP C 321208



Technical Details

Reference:
1502468/1502471

CODE: KK-1001-002

TP CA 11879



Technical Details

Reference:
5010 615 879

CODE: KK-1200-001

TP C 321051



Technical Details

Reference:
5010.130.797 G

CODE: KK-1201-001

CONNECTING EQUIPMENTS



TREYPART[®]

HANGER BRACKET



Technical Specifications

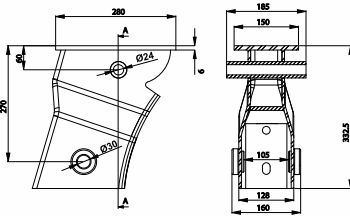

Technical Details Reference: 05.375.40.65.0

27 CM / 6 MM CODE: KL-1001-001

27 CM / 8 MM CODE: KL-1001-002

32 CM / 8 MM CODE: KL-1001-002

HANGER BRACKET



Technical Specifications

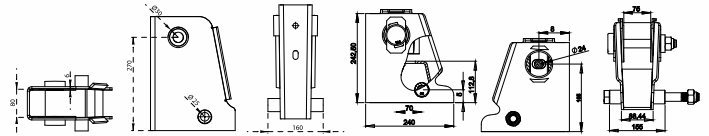

Technical Details Reference: 05.375.44.23.0

27 CM / 6 MM CODE: KL-1101-001

27 CM / 8 MM CODE: KL-1101-002

LIFTING DEVICE



Technical Details

SAF New M. CODE: KL-1200-002

SAF Old M. CODE: KL-1200-001

LIFTING DEVICE

Technical Specifications

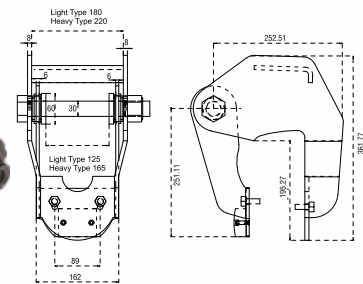

Technical Details

100 MM CODE: KL-1002-001

70 MM CODE: KL-1102-001

LIFTING DEVICE



Technical Details

SCHMITZ CODE: KL-1400-001

WEWELER CODE: KL-1400-002

LIFTING DEVICE



Technical Details

BPW CODE: KL-1300-001

BPW Eco CODE: KL-1300-003

UPPER CAP



Technical Specifications

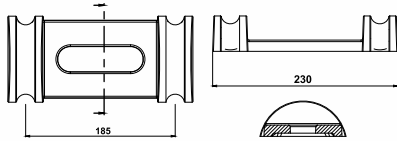

Technical Details

100 MM

CODE: YP-1200-002

LOWER CAP



Technical Specifications

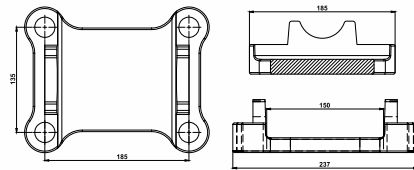

Technical Details

100 MM

CODE: YP-1200-001

VARIOUS PINS



Technical Details

CODE: YP-1000-001

SPRING PAD W SHOCK ABSORBER PIN



Technical Specifications

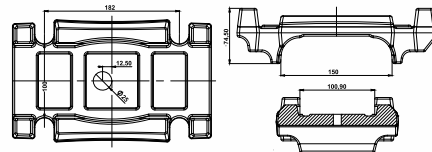

Technical Details

Spring Pad 100 MM W

CODE: YP-1200-003

SPRING BUSH



Technical Details

CODE: YP-1300-003

36' CHAMBER



Technical Details

Reference: 05.444.10.37.0

CODE: FK-1300-001

U BOLT



Technical Specifications

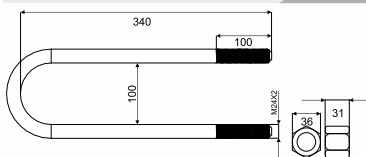

Technical Details

Reference: 03.138.44.18.4

24X10X34 CM

CODE: YP-1100-004

BRAKE EQUIPMENTS



TREYPART[®]

SPRING BRAKE ACTUATORS



Technical Details	Reference: 925 361 100 0
24 x 30	CODE: FK-1101-002
30 x 30	CODE: FK-1001-001

BRAKE CHAMBER



Technical Details	Reference: 423 106 900 0
24	CODE: FK-1101-001
30	CODE: FK-1001-002

SPRING BRAKE ACTUATORS FOR DISK



Technical Details	Reference: 03.130.00.40
16 x 24	CODE: FK-1200-001

BRAKE CHAMBER FOR DISK



Technical Details	Reference: 01.116.00.05
16	CODE: FK-1200-002

AUTOMATIC SLACK ADJUSTER



Technical Details	Reference: 05.574.82.87.3
	CODE: FC-1000-001

MANUEL SLACK ADJUSTER



Technical Details	Reference:
3 Holes	CODE: FC-1100-001
5 Holes	CODE: FC-1100-002

AIR RESERVOIR CLAMP KIT



Technical Details	
270 mm Set	CODE: ST-1001-002
380 mm Set	CODE: ST-1001-003

SLACK SPRING



Technical Details	
Short	CODE: FC-1001-002
Long	CODE: FC-1001-001

POLYEMIDE HOSES



Technical Details	
4 x 6	CODE: RK-1000-001
6 x 8	CODE: RK-1000-002
8 x 10	CODE: RK-1000-003
9 x 12	CODE: RK-1000-004
12 x 15	CODE: RK-1000-005

AIR RESERVOIR



Technical Details	
40 lt	CODE: HT-1000-001
60 lt	CODE: HT-1100-001
80 lt	CODE: HT-1200-001

FITTINGS



AIR HOSE



Technical Details	
M16	CODE: EL-1100-005

BRAKE SYSTEM & VALVES

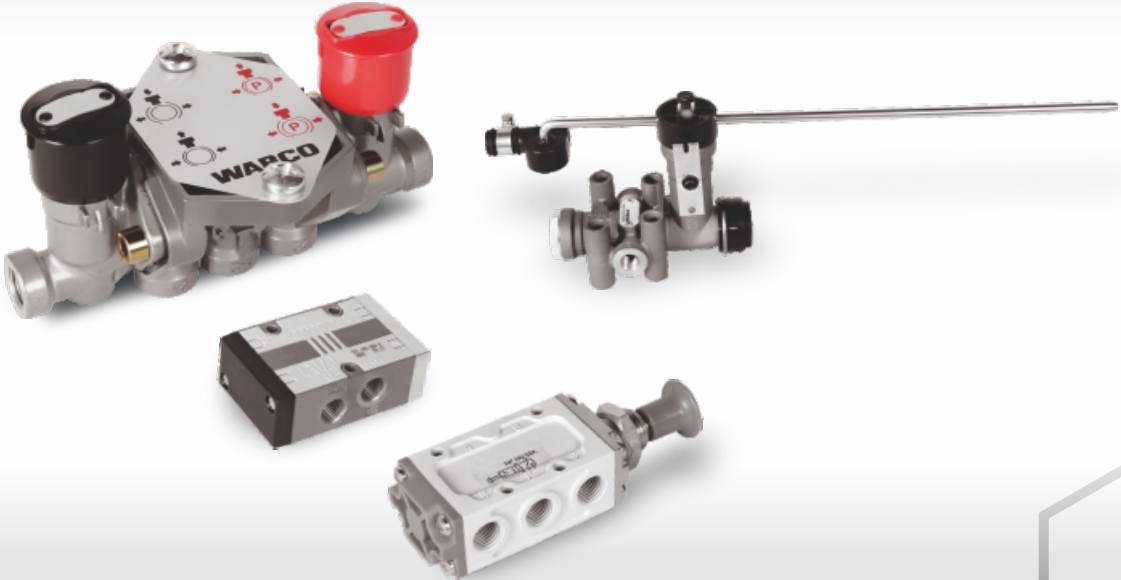

EBS KIT



Technical Details		Reference: 400 605 191 0
		CODE: VE-1000-001
Type	Product Name	PCS
480 102 033 0	2S Modulator	1
971 002 912 0	Prev Valve	1
463 084 041 0	Lift Axle Valve	1
449 413 050 0	Valve Cable 5m	1
463 032 020 0	Rotary Slide Valve	1
464 006 201 0	Balance Valve W/Switch	1
952 201 012 0	Coupling Red	1
952 201 011 0	Coupling Yellow	1
449 173 120 0	Main Plug Cable	1
449 723 030 0	Sensor Add. Cable 3m	2
441 032 808 0	Sensor Reader	2
899 760 510 4	Bushing	2
433 401 003 0	Linkage	1
899 200 922 4	System Label	1
813 000 009 3	EBS Label	1
813 000 008 3	Socket Label	1

ABS KIT



Technical Details		Reference: 400 602 898 0
		CODE: VE-1000-003
Type	Product Name	PCS
400 500 081 0	ABS Modulator 4S	1
449 126 120 0	ABS Main Plug Cable 12m	1
441 032 808 0	ABS Sensor Reader	4
899 760 510 4	ABS Sensor Bush	4
449 712 038 0	ABS Sensor Add. Cable	4
813 000 017 3	ABS Label	1
475 715 500 0	Auto Emergency Relay	1

AUTOMATIC RELAY EMERGENCY



Technical Details		Reference: 475 715 500 0
		CODE: VE-1001-012

CONNECTION CABLE



Technical Details		Reference: 449 723 030 0
3MT		CODE: VE-1001-005

ABS SENSOR



Technical Details		Reference: 441 032 808 0
		CODE: VE-1001-001

LEVELLING VALVE



Technical Details		Reference: 464 006 002 0
		Reference: 464 006 100 0
		CODE: VE-1001-015
With Switch		CODE: VE-1001-014

ROTARY SLIDE VALVE



Technical Details **Reference: 463 032 020 0**
CODE: VE-1001-013

AXLE LIFTING VALVE



Technical Details **Reference: 463 084 041 0**
CODE: VE-1001-017

PARK EMERGENCY VALVE



Technical Details **Reference: 971 002 912 0**
CODE: VE-1001-023

SOLENOID VALVE



Technical Details **Reference: 472 170 600 0**
CODE: VE-1001-018

CONNECTION CABLE



Technical Details **Reference: 963 001 051 0**
CODE: VE-1001-016

LIFTING BOX

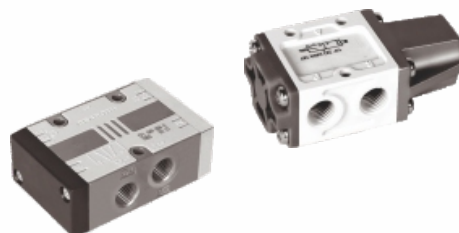

Technical Details **Reference: 571 040 000 0**
CODE: VE-1001-025

PULLER LIFTING



Technical Details	Reference: VE-1400-001
	CODE: VE-1400-001

PROTECTION VALVE



Technical Details	Reference: 201 002 001
	CODE: VE-1001-028

LEVELLING VALVE

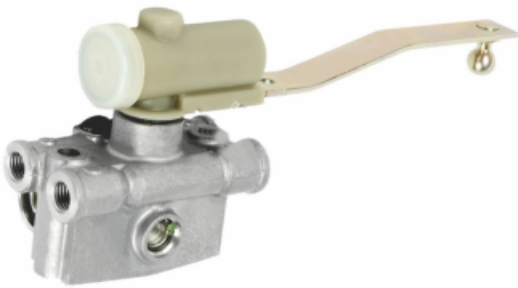

Technical Details	Reference: 0 500 005 001
	CODE: VE-1100-005

CHARGING VALVE

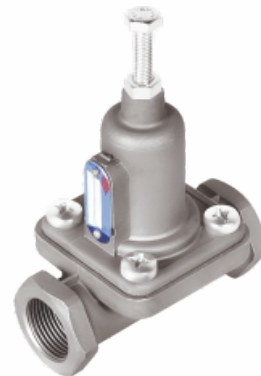

Technical Details	Reference: 434 100 125 0
	CODE: VE-1001-020

LOAD SENSING VALVE

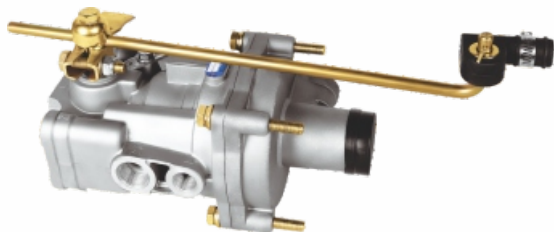

Technical Details	Reference: 475 712 000 0
	CODE: VE-1001-032

QUICK RELEASE VALVE



Technical Details	Reference: 973 500 000 0
	CODE: VE-1001-021

LIFT AXLE CONTROL VALVE



Technical Details

CODE: VE-1300-003

TRIPLE ONE WAY VALVE



Technical Details

CODE: VE-1200-002

MANOMETER



Technical Details

CODE: VE-1100-001

COUPLING HEADS



Technical Details

Reference: 452 200 011 0

452 200 211 0

952 201 001 0

CODE: VE-1002-001

CODE: VE-1001-009

CODE: VE-1001-007

HAND BRAKE VALVE



Technical Details

CODE: VE-1500-001

ELECTRICAL PARTS & WARNING SIGNS



LAMP SET



Technical Details	
Short Cable	CODE: EL-1000-002
Long Cable	CODE: EL-1000-001

ADAPTER CABLE



Technical Details	
	CODE: EL-1100-004

ABS CABLE



Technical Details	
	CODE: EL-1100-003

SOCKET



Technical Details	
	CODE: EL-1300-003

ELECTRICAL CABLE



Technical Details	
	CODE: EL-1100-001

REFLECTIVE BANDS



Technical Details	
	CODE: RE-1100-001

STICKERS



Technical Details

CODE: RE-1500-001

SAFETY WARNING



Technical Details

CODE: RE-1600-006

SAFETY WARNING



Technical Details

CODE: RE-1600-002

REFLECTOR FOR TRAILER



Technical Details

CODE: RE-1000-001

SAFETY WARNING



Technical Details

CODE: RE-1600-001

REFLECTOR FOR TRUCK



Technical Details

CODE: RE-1000-002

MUDGUARDS



TREYPART[®]

MUDGUARD SINGLE TYRE



Technical Details	
45 x 196 cm	CODE: DC-1000-001
45 x 196 cm Line	CODE: DC-1000-002

MUDGUARD DOUBLE TYRE W/STRIPE



Technical Details	
65 x 190	CODE: DC-1100-002
68 x 210	CODE: DC-1100-004

MUDGUARD SINGLE TYRE W/STRIPE



Technical Details	
45 x 212 cm Line	CODE: DC-1000-007

MUDGUARD SINGLE TYRE FOR THREE AXLE



Technical Details	
	CODE: DC-1000-003

MUDGUARD DOUBLE TYRE



Technical Details	
65 x 205 cm	CODE: DC-1100-001

MUDGUARD FLAT TOPPED



Technical Details	
30 x 153 cm	CODE: DC-1200-002
50 x 146 cm	CODE: DC-1200-001

MUDGUARD DOUBLE TYRE FOR TRUCK



Technical Details	
53 x 160 cm	CODE: DC-1200-004
62 x 175 cm	CODE: DC-1200-003

MUDGUARD FOR KRONE



Technical Details	
	CODE: DC-1300-003

HALF MUDGUARD



Technical Details	
65 x 90 cm	CODE: DC-1100-003
45 x 90 cm	CODE: DC-1000-004

MUDGUARD CONNECTOR



Technical Details	
Metal	CODE: DC-2300-001
Plastic	CODE: DC-2300-002

MUDGUARD FRUEHAUF & SCHMITZ

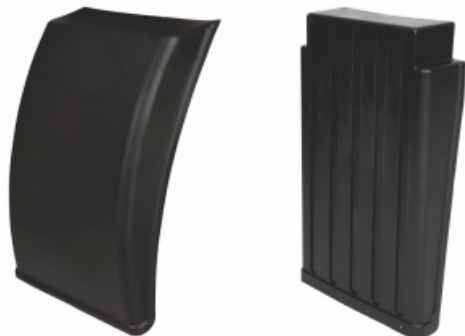

Technical Details	
Fruehauf	CODE: DC-1300-001
Schmitz	CODE: DC-1300-002

MUDGUARD PIPE



Technical Details	
53 cm	CODE: DC-2400-001
53 cm 2. Hole	CODE: DC-2400-003
75 cm	CODE: DC-2400-002

FOR MERCEDES ACTROS MP4



Technical Details	Reference: A.9605200007
Top	CODE: DC-2000-001
Front	CODE: DC-2000-002
Rear	CODE: DC-2000-003
Rubber Strap	CODE: DC-2000-005

FOR MAN TGA



Technical Details	Reference: 81664106606
Top	CODE: DC-1600-001
Front	CODE: DC-1600-002
Rear	CODE: DC-1600-003
Rubber Strap	CODE: DC-1600-004

FOR MERCEDES AXOR



Technical Details	Reference: 9305200007
Top	CODE: DC-1400-001
Front	CODE: DC-1400-003
Rear	CODE: DC-1400-002
Rubber Strap	CODE: DC-1400-004

FOR RENAULT - VOLVO - V2



Technical Details	Reference: 7420936772
Top	CODE: DC-1800-001
Front	CODE: DC-1800-002
Rear	CODE: DC-1800-002
Rubber Strap	CODE: DC-1800-003

FOR SCANIA



Technical Details	Reference: 1395276
Top	CODE: DC-1500-001
Front	CODE: DC-1500-002
Rear	CODE: DC-1500-003
Rubber Strap	CODE: DC-1500-004

FOR RENAULT - VOLVO - V3



Technical Details	Reference: 7421094383
Top	CODE: DC-1700-001
Front	CODE: DC-1700-002
Rear	CODE: DC-1700-003
Rubber Strap	CODE: DC-1700-004

FOR DAF XF105



Technical Details	Reference: 1328935
Top	CODE: DC-2100-001
Front	CODE: DC-2100-002
Rear	CODE: DC-2100-002
Rubber Strap	CODE: DC-2100-003

FOR DAF XF106



Technical Details	Reference: 1875551
Top	CODE: DC-2100-005
Front	CODE: DC-2100-006
Rear	CODE: DC-2100-007
Rubber Strap	CODE: DC-2100-008

FOR FORD CARGO



Technical Details	Reference: 11016315
Top	CODE: DC-1900-001
Front	CODE: DC-1900-002
Rear	CODE: DC-1900-002
Rubber Strap	CODE: DC-1900-003

MUDGUARD FOR MAN



Technical Details	
68 x 225 cm	CODE: DC-1601-001

BATTERY COVER AXOR



Technical Details	
	CODE: PL-1200-005

FOOT STEP FOR AXOR



Technical Details	
	CODE: PL-1200-010

OTHER EQUIPMENT



TREYPART[®]

LANDING GEAR



Technical Specifications

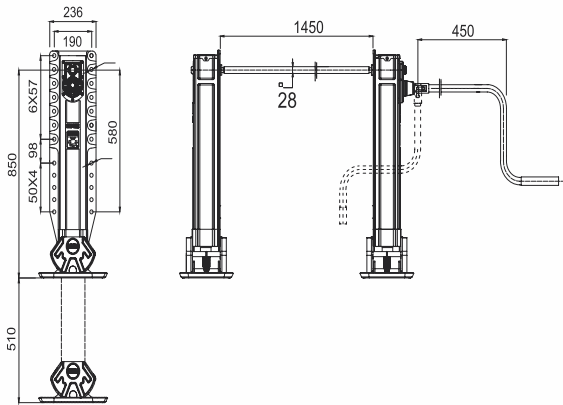

Technical Details

650 S	CODE: DP-1100-003
750 S	CODE: DP-1100-002
850 S	CODE: DP-1100-001

KING PIN



Technical Specifications

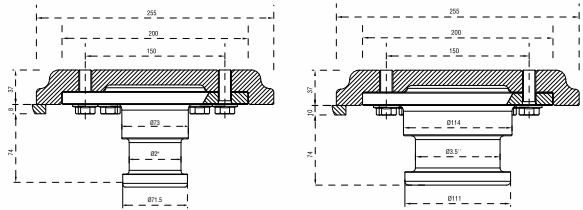

Technical Details

Reference: KZ1008, KZ1410	
2"	CODE: DP-1000-001
3,5"	CODE: DP-1001-001

SHOCK ABSORBER



Technical Details	Reference: N6885516
	CODE: DA-1000-001

LANDING GEAR PARTS



Technical Details

	CODE: DP-1101-002
	CODE: DP-1101-001

SPARE WHELL CARRIER PLATFORM



Technical Details

CODE: DP-1200-008

SPARE WHEEL CARRIER PLATFORM



Technical Details

CODE: DP-1200-004

SPARE WHELL CARRIER

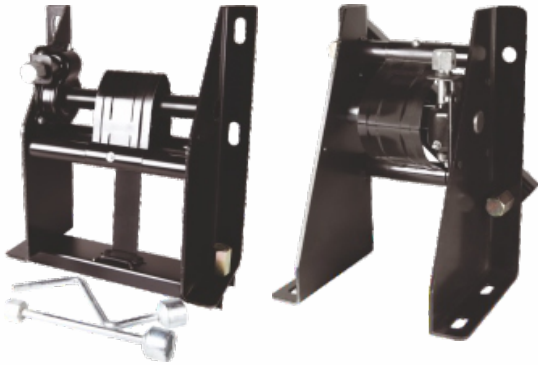

Technical Details

For Atego

CODE: DP-1200-003

For Truck

CODE: DP-1200-002

For Trailer

CODE: DP-1200-001

TWIST LOCKER SINGLE

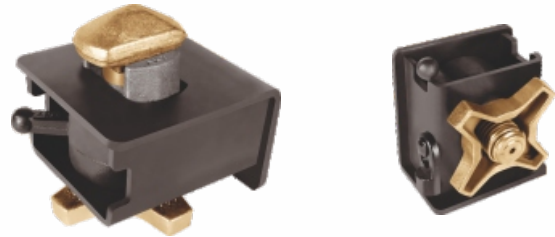

Technical Details

Big

CODE: DP-1300-001

Small

CODE: DP-1300-004

FIRE EXTINGUISHER BOX



Technical Details

Reference: 81664106606

690 x 320 x 250

CODE: PL-1000-001

LUGGAGE RACK



Technical Details

CODE: DP-1200-007

WATER TANK PLASTIC



Technical Specifications

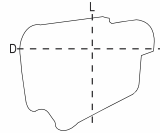

	L	D
30 L	36	34
50 L	42	44

Technical Details	
30 lt	CODE: ST-1200-001
50 lt	CODE: ST-1200-003

WATER TANK PLASTIC



Technical Details	
45 lt	CODE: ST-1200-002

WATER TANK



Technical Details	
25 lt	CODE: ST-1100-001
35 lt	CODE: ST-1100-002
60 lt	CODE: ST-1100-003
70 lt	CODE: ST-1100-004
90 lt	CODE: ST-1100-005

TOOLBOX



Technical Details	
40 cm	CODE: TD-1000-001
50 cm	CODE: TD-1000-002
60 cm	CODE: TD-1000-003
80 cm	CODE: TD-1000-004
100 cm	CODE: TD-1000-005
110 cm	CODE: TD-1000-006

TOOLBOX METAL



Technical Details	
80 cm	CODE: TD-1100-001
100 cm	CODE: TD-1100-002
120 cm	CODE: TD-1100-003
150 cm	CODE: TD-1100-004

WHEEL WEDGE



Technical Details	Reference: 7420936772
	CODE: PL-1000-002

ALUMINUM PROFILE



Technical Details	
600 cm	CODE: AP-1400-001
600 cm Corner	CODE: AP-1300-001

GUARD RAIL



Technical Details	
50 cm	CODE: AP-1000-001
70 cm	CODE: AP-1000-002

ANTISPRAY MUDFLAP



Technical Details	
	CODE: DC-2500-001

BICYCLE BARRIER



Technical Details	
10 cm	CODE: AP-1100-001
46 cm	CODE: AP-1100-002
50 cm	CODE: AP-1100-003

CABIN CLEANING HOSE



Technical Details	
	CODE: EL-1100-006

FIFTH WHEEL WEARING RING



Technical Details	
	CODE: BT-1000-002
	CODE: BT-1000-003

FIFTH WHEEL REPAIR KIT



Technical Details	
	CODE: BT-1300-002

FIFTH WHEEL RAISING WEDGE



Technical Details	
5 cm	CODE: BT-1100-002

WEDGE



Technical Details	
	CODE: KR-1000-001

MALE

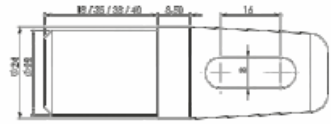

Technical Details	
	CODE: KR-1000-003

HINGLE

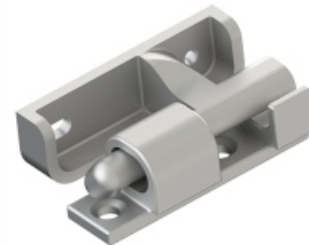

Technical Details	
	CODE: KR-1200-002

SHEET BAR

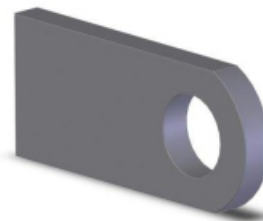

Technical Details	
50 x 10 10,5 cm	CODE: KR-1200-003

HOOK



Technical Details	
8 mm	CODE: KR-1100-003

BUFFER



Technical Details

CODE: KR-1600-002

ROLLER BUFFER



Technical Details

CODE: KR-1500-002

TOOLBOX LOCK



Technical Details

Black CODE: KR-1700-002

Chrome CODE: KR-1700-001

Plastic CODE: KR-1700-005

REAR DOOR RETAINER



Technical Details

Short CODE: KR-1400-001

Long CODE: KR-1400-002

OIL TANK

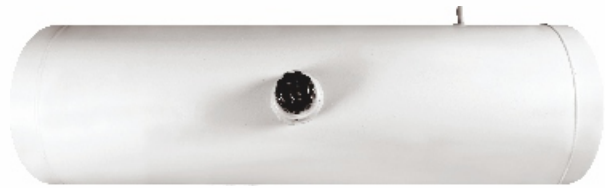

Technical Details

150 lt CODE: HD-1000-001

160 lt CODE: HD-1000-002

180 lt CODE: HD-1000-003

HYDRAULIC QUICK COUPLING



Technical Details

CODE: HD-1300-001

TANK COVER



Technical Details

CODE: HD-1001-001

SPIRAL HOSE



Technical Details

CODE: HD-1700-001



TREYPART®

📍 Horozluhan Mahallesi, Rüya Sokak No:10,
Selçuklu/Konya/TÜRKİYE

☎ +90 332 249 82 88

✉ info@treypart.com

🌐 www.treypart.com